

Historical Affairs and Landmark Review Board

Arlington County, Virginia

HALRB Case 17-04 (HP1700004)

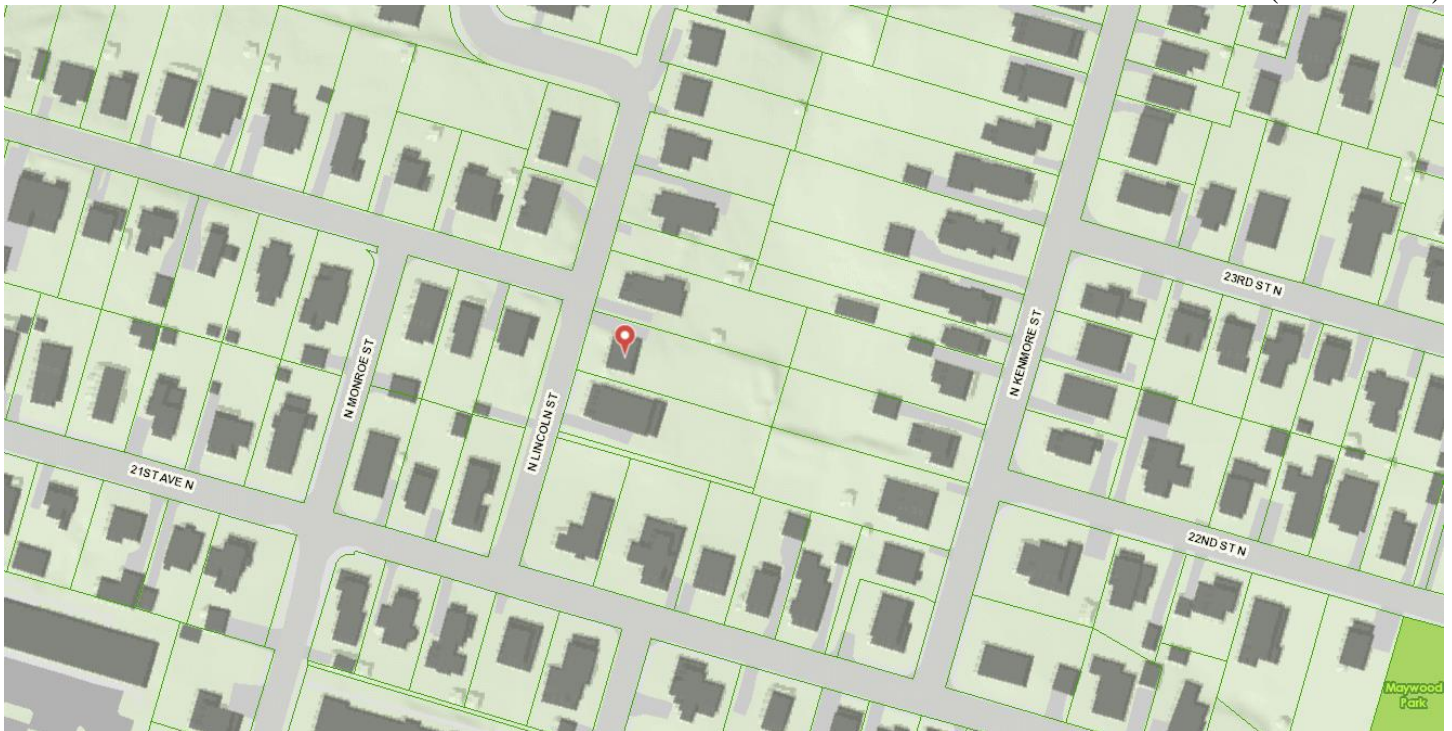

A request by Melissa & Michael Paul, owners of 2911 22nd Street North in the Maywood Neighborhood Historic District, to install shutters on the facade.

ARLINGTON COUNTY, VIRGINIA
HISTORICAL AFFAIRS AND LANDMARK REVIEW BOARD
APPLICATION FOR CERTIFICATE OF APPROPRIATENESS

DATE 2/17/17

Z-	-	-HD	RPC#
(TO BE COMPLETED BY STAFF)			

DESIGNATED PROPERTY:

Name of Historic District

Maywood

Address of Building

2911 22nd Street North

OWNER:

Name

Melissa & Michael Paul

Address (if different)

Phone (Home)

571 606 0699

(Work)

EMAIL: Cell

Melissaepaul@gmail.com

PERSON FILING APPLICATION, IF OTHER THAN OWNER:

Name

Address

Phone (Home)

(Work)

Relationship to Applicant

PROJECT ARCHITECT/ENGINEERS/CONTRACTORS:

PURPOSE OF APPLICATION:

Repair (change of materials)

Alteration

Addition

Fence

Demolition

New construction

Relocation

Outbuildings

Tree Removal

Grading

Sign

Other

Will an application related to this property go before any of the following? Board of Zoning Appeals

Planning Commission County Board

Other (please specify) _____

Does the proposed work require a building permit?

YES

NO

Is any demolition anticipated? YES NO

If yes, please describe _____

OVERVIEW OF PROPOSED WORK (ATTACH ADDITIONAL SHEETS IF NECESSARY):

Description:

Add Board & Batten shutters to front of house
(3 windows)

LETTER OF TRANSMITTAL

Historical Affairs & Landmark Review Board
c/o Historic Preservation Program
2100 Clarendon Boulevard, Suite 700
Arlington, VA 22201

Dear Review Board Members:

Enclosed is an application for a Certificate of Appropriateness and the following attachments:

Drawing(s) -- Indicate scale on each drawing.

Site Plan / Plat _____

Elevation _____

Floor Plan _____

Section _____

Detail _____

Photograph(s) – Please indicate number of photographs.

Color 1 Black/White (2)

Material Samples/Manufacturer's Catalog Cuts – Please describe all material exhibits.

(2) Hinge straps & shutter dogs

YOUR SIGNATURE BELOW CONFIRMS YOUR CONSENT TO THE FOLLOWING:

1. I understand that these materials will be placed in the Historic Preservation Program's building file for information about my property following the public hearing.
2. I understand it is my responsibility to inform my adjacent neighbors of my building and construction plans for this project.
3. I hereby grant permission to the County's Historic Preservation Code Inspector to enter my property during the application and construction phases of my project.
4. I hereby grant permission to the County's Historic Preservation Code Inspector to take photographs of my property, including the existing conditions, during the construction phase, and after the project is completed.

(Signed)

Melissa E Paul

Date 2/17/17



PE-5956

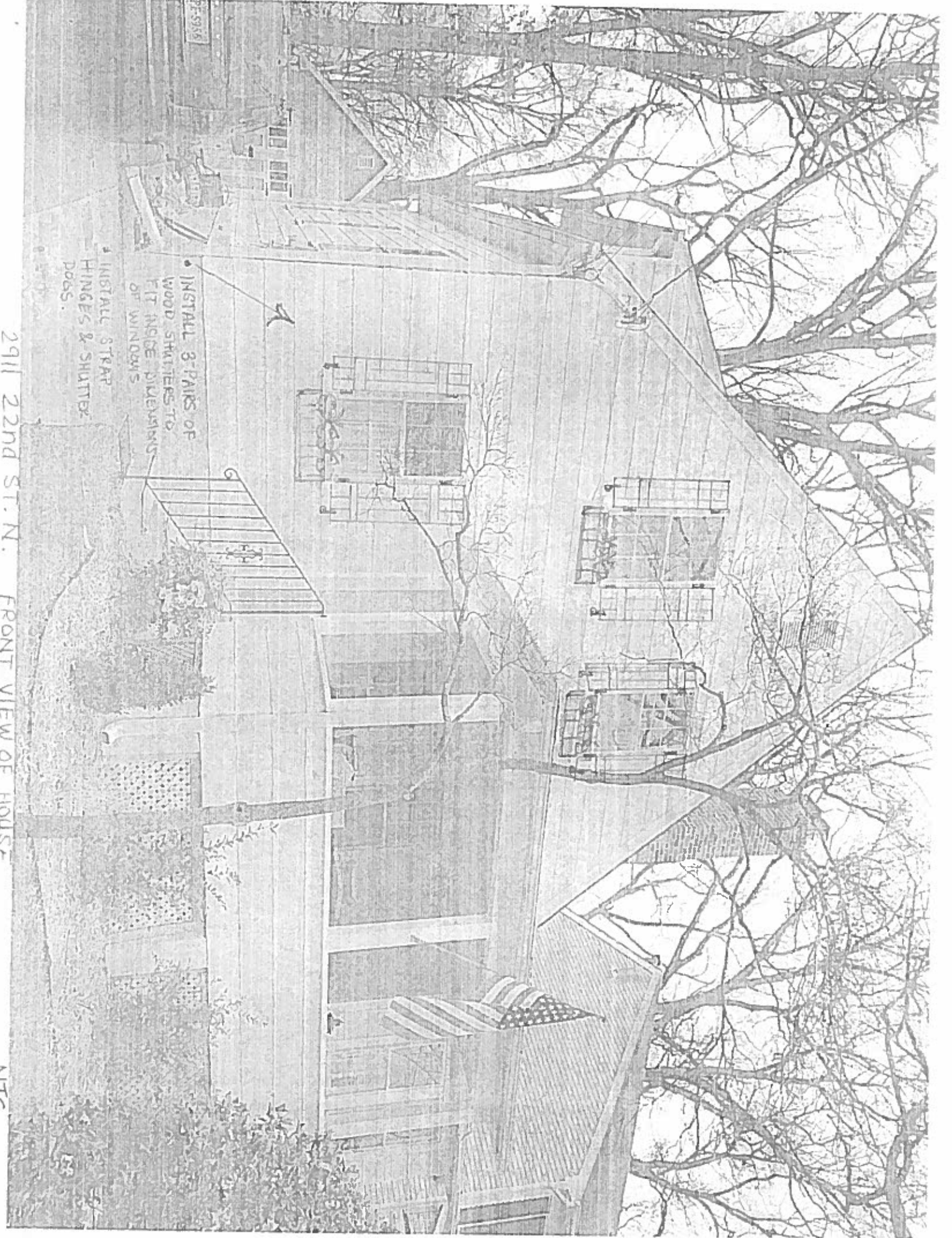

• INSTALL 3-PAIRS OF WOOD SHUTTERS TO FIT INSIDE DIMENSIONS OF WINDOWS

• INSTALL STRAP HINGES & SHUTTER DOGS.

2911 22nd ST. N. FRONT VIEW OF HOUSE

NTS

Board & Batten style shutter.
All wood construction (to be painted)

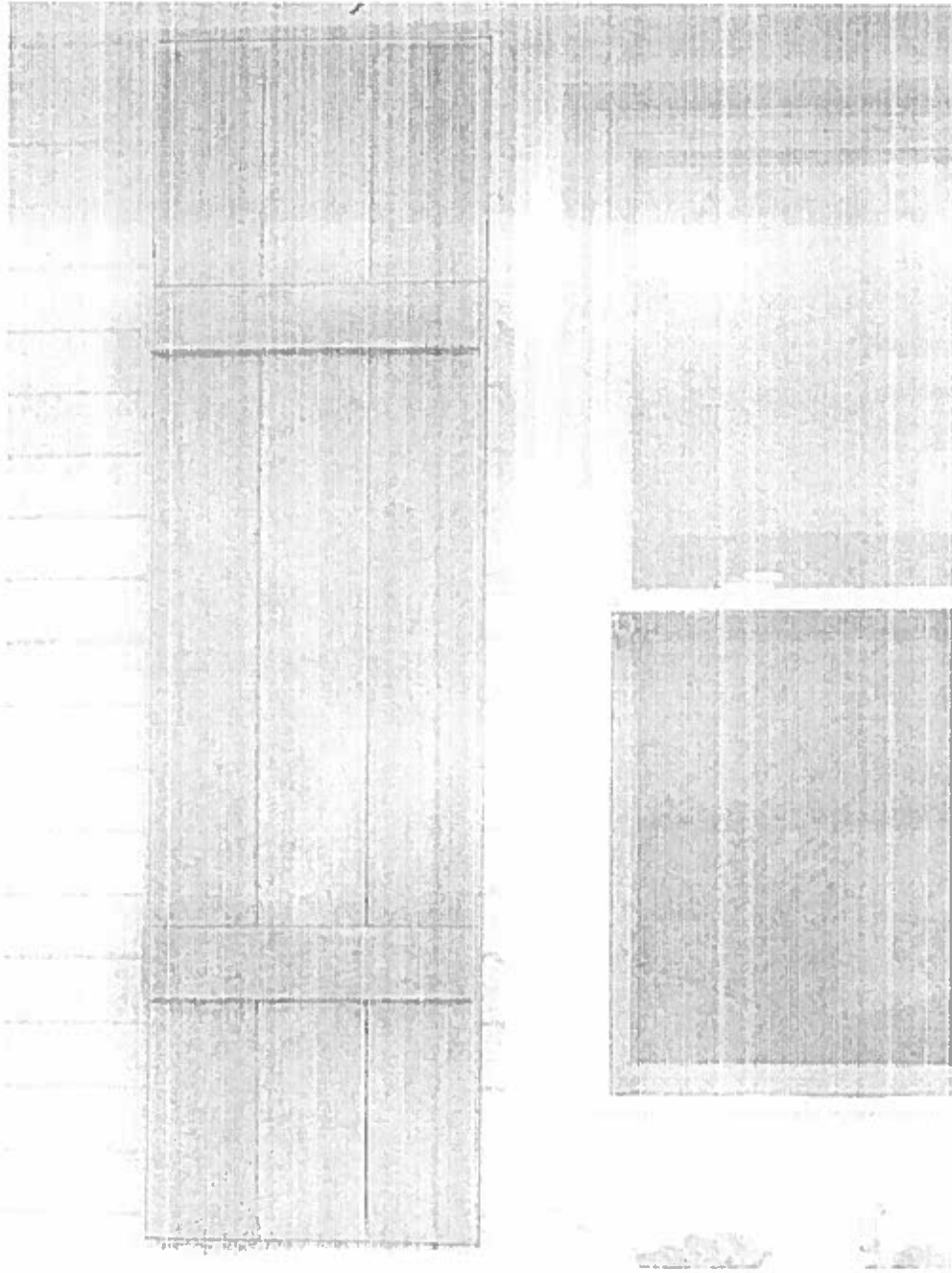

(*) STYLE OF SHUTTER



PAIR OF GALVANIZED IRON RAT TAIL SHUTTER DOGS - POST MOUNTED

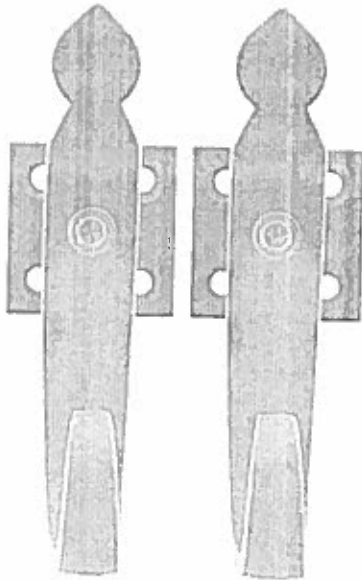

Features

- Heavy Cast Iron
- Authentic Colonial Era Design
- Enhances Historic Look and Feel
- Complete Set for One Window
- Galvanized and Powder Coated to Resist Rust

Details

SKU: SHD-150
 Category: Hardware
 Home Style: Colonial
 Material: Cast Iron

Colonial
 Pair
 8 Matching Phillips Head Screws
 1 to 2 Business Days [More info >](#)
 5 Year Warranty

SKU: SHD-150

Price: \$29.19

Description & Dimensions

Despite their name, these rat tail tie backs are an elegant addition to any home. An authentic colonial design, they're made of heavy duty cast iron, then galvanized and finished with a rust-resistant black powder coat. Easily attached to wood siding with the included mounting plate and post.

Dimensions: 6" H x 1" W x 2" projection (at curl). Mounting Plate: 2" H x 2" W x 3/16" Thick. Post projects 2 1/4".

Items in This Family:



People Interested in This Item Also Liked...

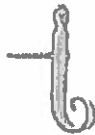

Pair of Plate-Mount Classic Shutter Dog Pair of Galvanized Iron Rat Tail
 From \$22.79



Pair of Galvanized Iron English Rat Tail Pair of Shutter Anti-Vibrators
 From \$28.99



Pair of Large Iron Scroll Shutter Dog Pair of Galvanized Iron Scroll
 From \$29.19



www.HouseofAntiqueHardware.com (888) 223-2545 7:00 am - 5:30 pm M-F, Pacific

PAIR OF 3/4" OFFSET GALVANIZED IRON SHUTTER STRAP HINGES WITH PLATE PINTLES

Features

- Iron and Steel Construction
- Galvanized and Powder Coated to Resist Rust
- Hinges are Lift Off for Easy Installation and Removal
- Authentic Colonial Era Design
- Reversible for Left or Right Handing

Details

Style	Colonial
Item Sold As	Set of 2 Hinges and 2 Pintles
Included Hardware	12 Matching Screws
Usually Ships In	1 to 2 Business Days More info >
Warranty	5 Year Warranty

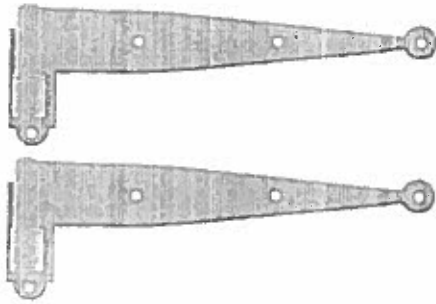

Strap Hinge Size - Choose -

1 1/2" (075) (125)

Price: \$21.89 – \$31.59

Description & Dimensions

These traditional Colonial style hinges are still popular today! The straps are forged out of steel and the pintles are made of solid cast iron, both galvanized. These versatile hinges can be mounted to show either when the shutters are open or closed. The rough textured black powder coating provides a great period look and helps reduce rust. The hinges lift off and are reversible, making installation and maintenance simple. These sturdy hinges will last a lifetime.

Dimensions: Strap width: 1 5/8". Strap Lengths: 10", 12", 14" & 16" (from end to center of pintle hole). Thickness: 1/16" (2mm). Offset: 3/4" (from back of strap to center of pintle). Throw: 1 1/2". Mounting plate: 3 3/8" H x 1 1/4" W. pintle rod: 7/16" diameter.

[Technical Info with Diagram](#)

Available Options

People Interested In This Item Also Liked...



Pair of 1 1/2" Offset Galvanized Iron From \$22.29



Pair of Traditional Inset Shutter Hinges From \$21.95



Pair of Shutter Strap Hinges with Plate Pintles From \$28.52



Pair of 3/4" Offset Galvanized Iron Shutter Strap Hinges From \$25.25

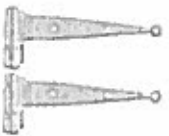

Pair of Shutter Strap Hinges with Plate Pintles From \$36.77



Pair of Vertical or Middle Strap Hinges From \$25.19