

# Historical Affairs and Landmark Review Board

Arlington County, Virginia

HALRB Case 16-22 (HP1600063)

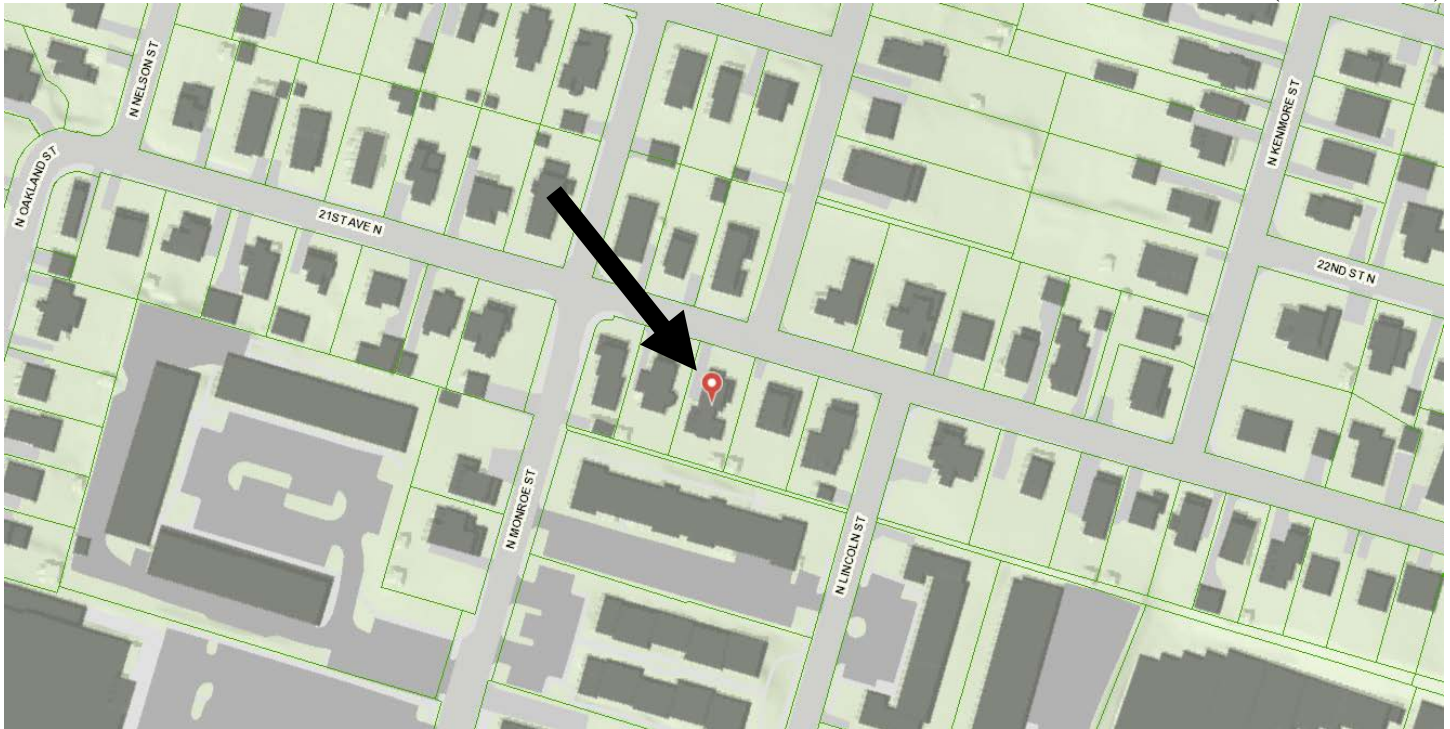

A request by Liz Rugaber, owner of 3500 21<sup>st</sup> Avenue North in the Maywood Historic District, to replace the three-tab asphalt shingle roof with architectural shingles.

For DRC (*circle those present*): **Robert Dudka, Charles Craig, Charles Matta, Andrew Wenchel, Tova Solo, Joan Lawrence, John Peck**

For Arlington County (*circle those present*): **Cynthia Liccese-Torres, Rebecca Ballo, John Liebertz**

---

Case # 16-22 Agenda Item # 6

Application Complete

Application Incomplete

Applicant(s): Liz Rugaber

For Applicant(s):

(See attached application for applicant, address, name of property and property description, drawings, photographs, and proposed scope of work.)

Design Recommendations:

1. Consider monochromatic shingles.

**Findings:**

Return to next DRC meeting

Send to HALRB

**If sent to HALRB, recommended action is:**

Place on consent agenda

Place on discussion agenda:

Recommend approval of CoA, with DRC design recommendations and/or additional information provided

Recommend deferral of ruling on CoA (explanation):

Recommend denial of CoA (explanation):

No recommendation.



HISTORICAL AFFAIRS AND LANDMARK REVIEW BOARD  
ARLINGTON COUNTY, VIRGINIA

## CERTIFICATE OF APPROPRIATENESS STAFF REPORT

**TO:** HALRB  
**FROM:** John Liebertz, Historic Preservation Planner  
**DATE:** October 14, 2016  
**SUBJECT:** 3500 21<sup>st</sup> Avenue North, Case 16-08, Maywood Historic District

### **Background Information**

The house is a pre-1912 Queen Anne dwelling. The building is a contributing resource to the Maywood National Register Historic District, and is described as follows:

The two-bay-wide, wood-frame dwelling rests on a solid parged foundation. It is clad in weatherboard and has a hipped roof sheathed in asphalt shingles. It has a one-story, three-bay, wood-frame wrap-around front porch on columns and one-over-one wood-sash windows. Window and door surrounds have molded lintels. Other notable features include a gable-roof dormer and wide, overhanging eaves.

### **Proposal**

The applicant proposes to replace the existing three-tab asphalt shingle roof with an architectural shingle.

### **DRC Review**

The DRC heard this application in October 2016. The committee recommended that this application be placed on the consent agenda for the October 19, 2016, HALRB hearing.

### **Discussion and Recommendation**

Architectural shingles are an appropriate choice and are regularly approved in the Maywood Local Historic District. Therefore, staff finds that the requests meet the intent of Chapter 5: Exterior Renovation of the *Maywood Design Guidelines* and recommends approval.