

ARLINGTON COUNTY, VIRGINIA
HISTORICAL AFFAIRS AND LANDMARK REVIEW BOARD
APPLICATION FOR CERTIFICATE OF APPROPRIATENESS

DATE _____ Z- _____ - _____ -HD _____ RPC# _____
(TO BE COMPLETED BY STAFF)

DESIGNATED PROPERTY:

Name of Historic District _____
Address of Building _____

OWNER:

Name _____
Address (if different) _____
Phone (Home) _____ (Work) _____
EMAIL: _____

PERSON FILING APPLICATION, IF OTHER THAN OWNER:

Name _____
Address _____
Phone (Home) _____ (Work) _____
Relationship to Applicant _____

PROJECT ARCHITECT/ENGINEERS/CONTRACTORS:

PURPOSE OF APPLICATION:

Repair (change of materials) Alteration Addition Fence
 Demolition New construction Relocation Outbuildings
 Tree Removal Grading Sign Other

Will an application related to this property go before any of the following? Board of Zoning Appeals
 Planning Commission County Board Other (please specify) _____

Does the proposed work require a building permit? YES NO
Is any demolition anticipated? YES NO If yes, please describe _____

OVERVIEW OF PROPOSED WORK (ATTACH ADDITIONAL SHEETS IF NECESSARY):

Description: _____

LETTER OF TRANSMITTAL

Historical Affairs & Landmark Review Board
c/o Historic Preservation Program
2100 Clarendon Boulevard, Suite 700
Arlington, VA 22201

Dear Review Board Members:

Enclosed is an application for a Certificate of Appropriateness and the following attachments:

Drawing(s) -- Indicate scale on each drawing.

Site Plan / Plat	_____
Elevation	_____
Floor Plan	_____
Section	_____
Detail	_____

Photograph(s) – Please indicate number of photographs.

Color	_____	Black/White	_____
-------	-------	-------------	-------

Material Samples/Manufacturer’s Catalog Cuts – Please describe all material exhibits.

YOUR SIGNATURE BELOW CONFIRMS YOUR CONSENT TO THE FOLLOWING:

1. I understand that these materials will be placed in the Historic Preservation Program’s building file for information about my property following the public hearing.
2. I understand it is my responsibility to inform my adjacent neighbors of my building and construction plans for this project.
3. I hereby grant permission to the County’s Historic Preservation Code Inspector to enter my property during the application and construction phases of my project.
4. I hereby grant permission to the County’s Historic Preservation Code Inspector to take photographs of my property, including the existing conditions, during the construction phase, and after the project is completed.

(Signed)

Date _____

Application Checklist

In order to facilitate the review by the DRC and the HALRB, use the Application Checklist provided below, and please check all that apply.

<p>General</p> <p><input type="checkbox"/> Application Form (see Appendix D)</p> <p><input type="checkbox"/> Vicinity / Plat Plan</p> <p><input type="checkbox"/> Existing Condition Photographs</p> <p>Site Plan</p> <p><input type="checkbox"/> Outline of adjacent buildings</p> <p><input type="checkbox"/> North Arrow / Names of adjacent streets</p> <p><input type="checkbox"/> Required zoning setbacks</p> <p><input type="checkbox"/> Location / type of existing trees of 15" caliper or greater</p> <p><input type="checkbox"/> Location / type of new / replacement trees</p> <p>Elevations</p> <p><input type="checkbox"/> Elevations Scale (1/8" = 1' min)</p> <p><input type="checkbox"/> Existing versus new construction</p> <p><input type="checkbox"/> Dimensions of new work</p> <p><input type="checkbox"/> Height of floors and roof ridge</p> <p>Windows</p> <p><input type="checkbox"/> Type (e.g., double hung)</p> <p><input type="checkbox"/> Size (e.g., 30" wide x 42" high)</p> <p><input type="checkbox"/> Style (e.g., 6 over 1)</p> <p>Exterior Cladding</p> <p><input type="checkbox"/> Type (e.g., wood lap siding)</p> <p><input type="checkbox"/> Size (e.g., 6" weather)</p> <p><input type="checkbox"/> Trim Dimensions</p>	<p>Miscellaneous</p> <p><input type="checkbox"/> Historical Photos / Drawings</p> <p><input type="checkbox"/> County Arborist Report</p> <p><input type="checkbox"/> Perspective Drawings / Renderings</p> <p><input type="checkbox"/> Model</p> <p>Floor Plans</p> <p><input type="checkbox"/> Floor Plan Scale (1/8" = 1' min)</p> <p><input type="checkbox"/> North Arrow</p> <p><input type="checkbox"/> Existing versus new construction</p> <p><input type="checkbox"/> Dimensions of new and existing work</p> <p><input type="checkbox"/> Area of existing new work</p> <p><input type="checkbox"/> Section(s)</p> <p>Drawing Details</p> <p><input type="checkbox"/> Porch rail details (refer to standard)</p> <p><input type="checkbox"/> Wall Section Detail</p> <p><input type="checkbox"/> Eave Detail</p> <p><input type="checkbox"/> Other</p> <p>Catalog Information (Samples and Specifications)</p> <p><input type="checkbox"/> Doors and Windows</p> <p><input type="checkbox"/> Cladding / Siding Materials</p> <p><input type="checkbox"/> Roofing Materials</p> <p><input type="checkbox"/> Other</p>
---	--

SUBMISSION REQUIREMENTS											
* = REQUIRED											
0= MAY BE REQUIRED, CHECK WITH STAFF											
PROJECT	APPLICATION	PHOTOGRAPHS	SITE PLAN	VICINITY PLAN	ELEVATIONS	DETAIL DRAWINGS	FLOOR PLANS	SAMPLE/SPECS	LANDSCAPEPLAN/ ARBORIST REPORT	3-D VIEWS	MODEL
NEW CONSTRUCTION	*	*	*	*	*	*	*	*	*	0	0
ADDITIONS	*	*	*	*	*	*	*	*	*	0	0
PARTIAL/TOTAL DEMOLITION	*	*	*	*	*	0	*	*	*		
DECKS/PORCHES	*	*	*	*	*	*	0	*	0		0
FENCES/WALLS	*	*	*	0	*	0		*	0		
DRIVES/WALKS	*	*	*	0				*	0		
ALTERATIONS	*	*	*	0	*	*	0	*	0		0
SIGNAGE	*	*	0		*	*		*			0
MAJOR LANDSCAPING/REGRAIDING	*	*	*	*	0				*		0
TREE REMOVAL	*	*	*	0					*		

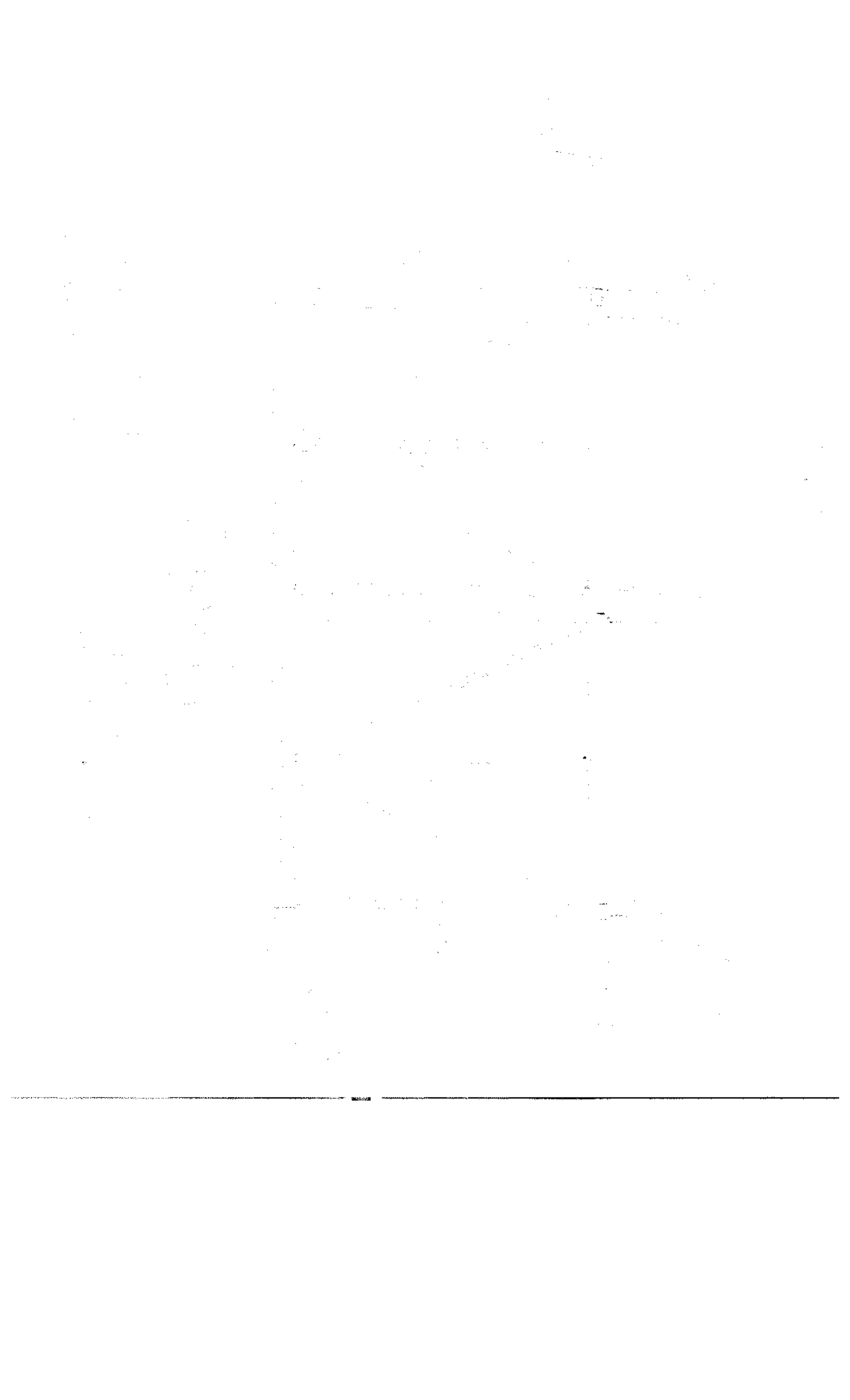

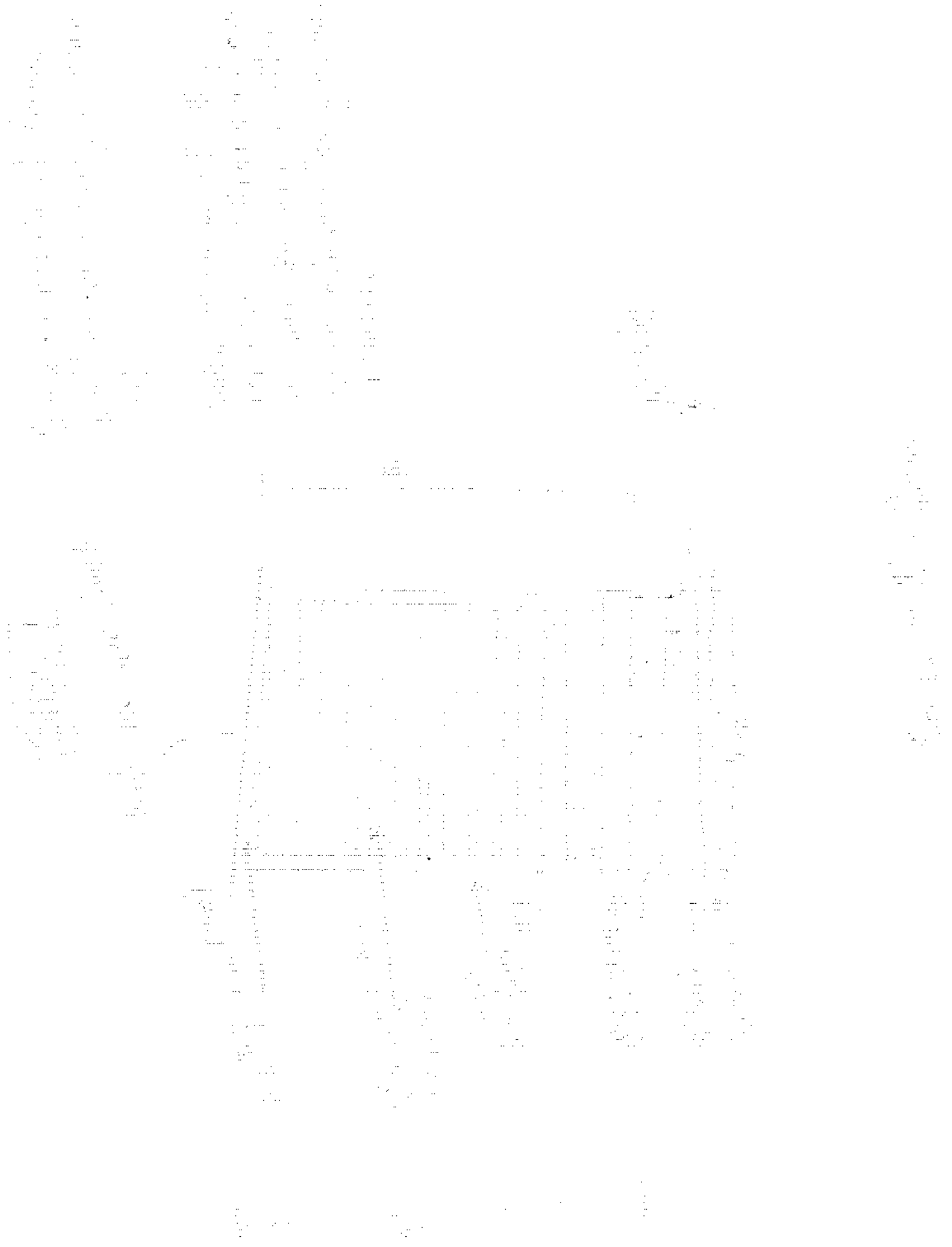

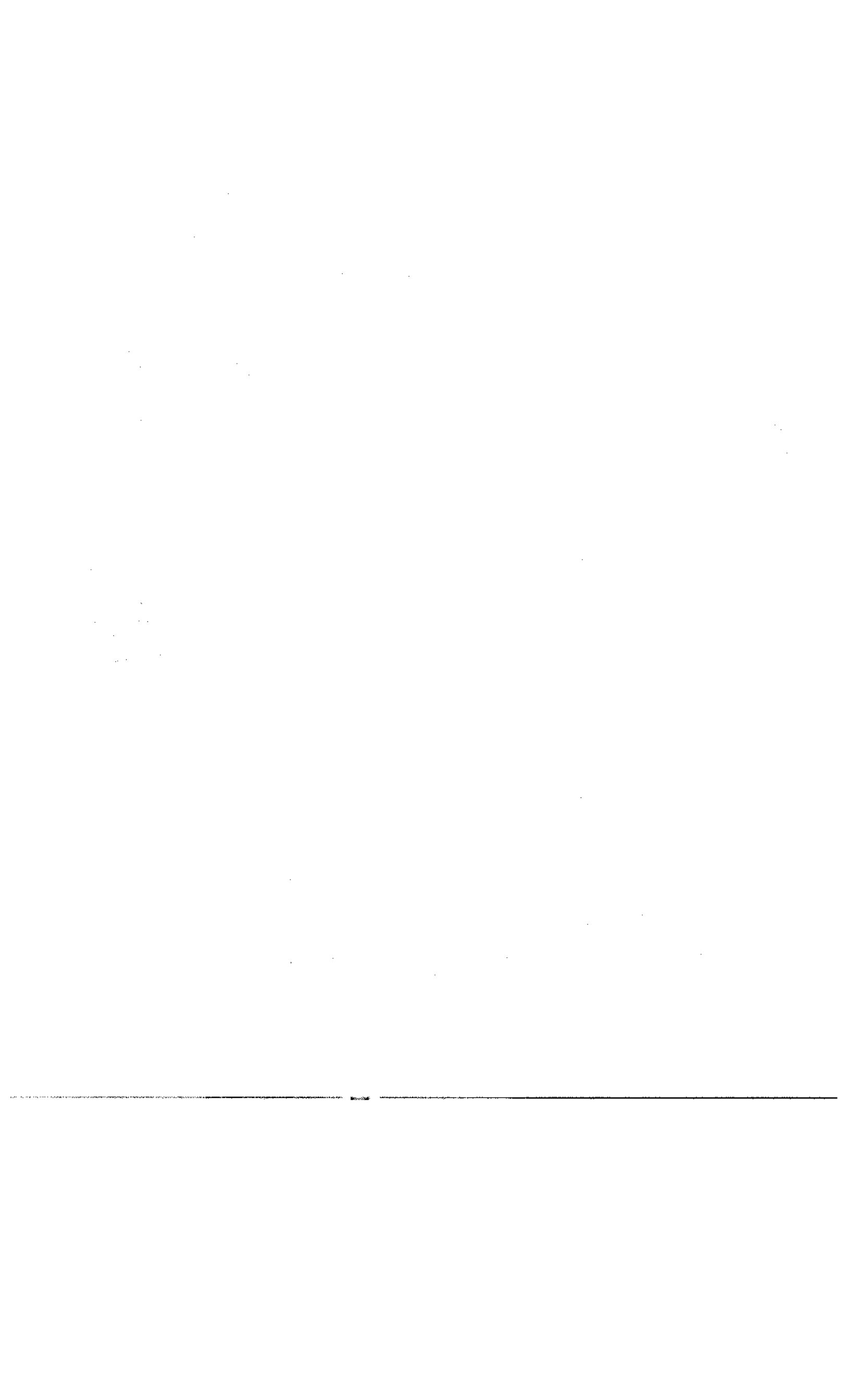

Concrete blocks - possibly
blocks reclaimed from
historic Arlington structure.

BASE / FOUNDATION

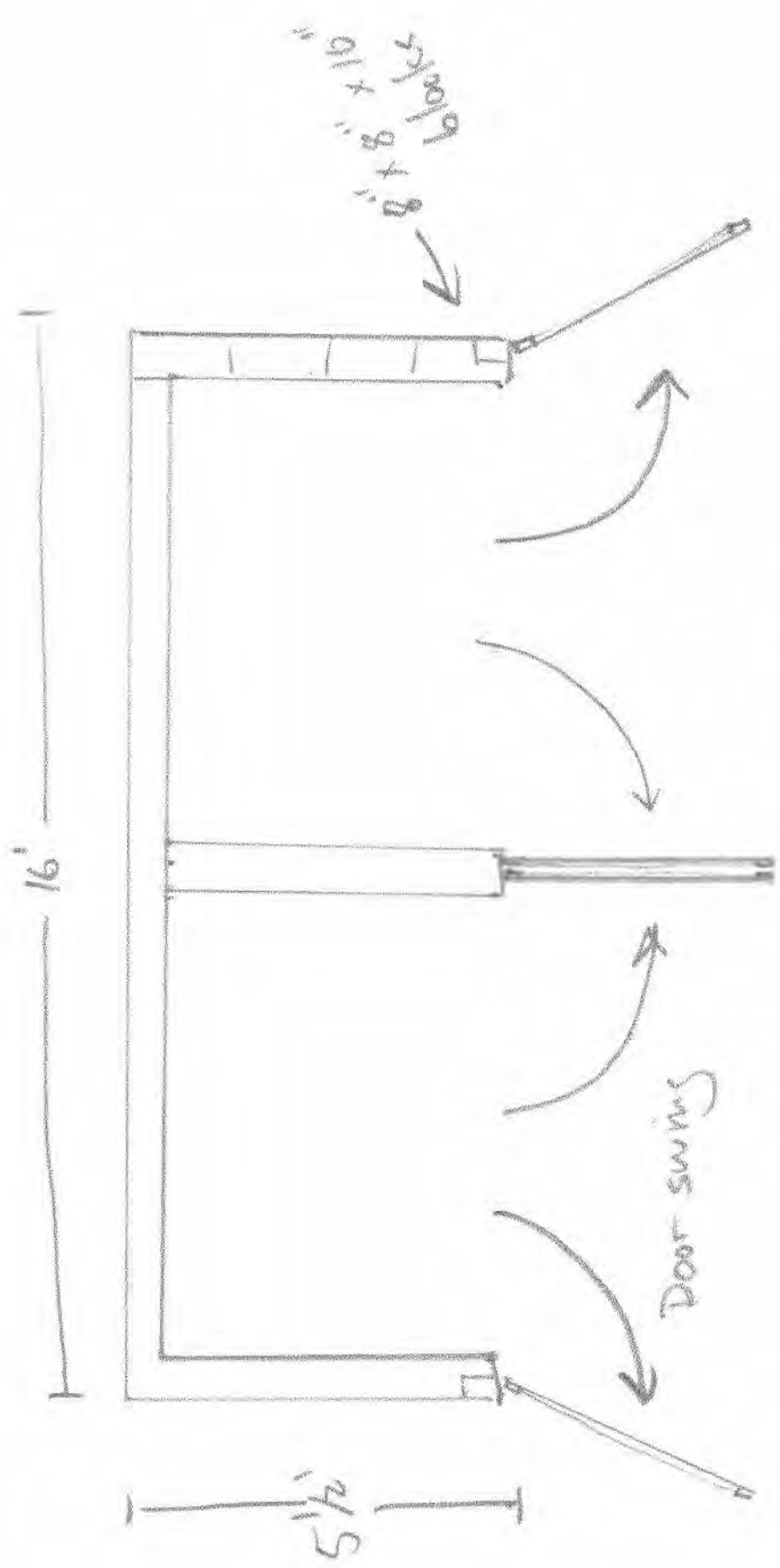

Scale - 1' = 1 cm



More saving. More doing.

[Share](#) [Email](#) [Print](#)



[Zoom](#) [More Views](#)

Everbilt 6-1/2 in. Zinc Plated Heavy Duty Door Pull

Model # 15460 Internet # 202034119 Store SKU # 854597

(1) [Write a Review](#)

\$5.48 /BG-Bag

Ships FREE with \$45.00 Order

This item cannot be shipped to the following state(s):
AK, GU, HI, PR, VI

[Product Description](#) [Specifications](#) [Customer Reviews](#) [More Info](#) [Shipping Options](#)

PRODUCT DESCRIPTION

The Everbilt 6-1/2 in. Heavy Duty Door Pull is ideal for gates, sheds or barn doors. It features a non-handed, utility design that provides a comfortable grip for either hand. Easy to install.

- Made of steel
- Zinc plated finish
- Screws included
- Non-handed design for left- or right-handed use
- MFG Brand Name : Everbilt
- MFG Model # : 15460
- MFG Part # : 15460

[Return To Top](#)

SPECIFICATIONS

Assembled Depth (in.)	2.25 in	Assembled Height (in.)	6.5 in
Assembled Width (in.)	1.25 in	Builders Hardware Product Type	Other Door Hardware
Center to center measurement (in.)	6	Color	Zinc Plated Finish
Color Family	Metallics	Item Package Type	Plastic Container
Manufacturer Warranty	none	Material	Steel
Package quantity	1	Product Depth (in.)	2.25
Product Height (in.)	6.5	Product Width (in.)	1.25 in
Projection (in.)	2.25	Returnable	90-Day
Type	Lever	Window Repair Type	Handles
Window Type	Utility		



More saving. More doing.

[Share](#) [Email](#) [Print](#)



Everbilt 3-1/2 in. Zinc Plated Heavy Duty Tee Hinge

Model # 15064 Internet # 202034059 Store SKU # 163241

(2) [Write a Review](#)

\$4.97 /EA-Each

Ships FREE with \$45 Order

[Zoom](#)

This item cannot be shipped to the following state(s):
AK, GU, HI, PR, VI

Finish: Silver



[Product Description](#) [Specifications](#) [Customer Reviews](#) [More Info](#) [Shipping Options](#)

PRODUCT DESCRIPTION

The Everbilt 3-1/2 in Heavy Duty Tee Hinge is ideal for surface applications on doors, gates, sheds and tool boxes. Its bearing design eliminates metal to metal contact. Easy to install.

- Made of steel
- Zinc plated finish
- Screws not included
- For right or left-hand applications
- Offset screw holes provide extra strength and prevent wood splitting
- MFG Brand Name : Everbilt
- MFG Model # : 15064
- MFG Part # : 15064

[Return To Top](#)

SPECIFICATIONS

Assembled Depth (in.)	0.62 in	Assembled Height (in.)	4.25 in
Assembled Width (in.)	3.5 in	Builders Hardware Product Type	Gate Hinge
Commercial Hardware Type	Hinges	Commercial/Residential	Commercial / Residential
Fasteners included	No	Finish	Silver
Finish Family	Silver Metallic	Hinge type	Surface mount
Item Package Type	No Package	Manufacturer Warranty	None
Material	Steel	Mounting type	Gate



More saving. More doing.

[Share](#) [Email](#) [Print](#)

Fabral 2-1/2" UTILITY GA CORRUGATED 2X8'

Model # 4736006000 Store SKU # 603546

(1) [Write a Review](#)

[View Local Store Pricing](#)

Available for In-Store Pick Up



[Zoom](#)

[Product Description](#) [Specifications](#) [Customer Reviews](#) [More Info](#) [Shipping Options](#)

PRODUCT DESCRIPTION

The 26 in. x 8 ft. Corrugated Steel Utility Roof Panel can cover up to approximately 16 sq. ft. The easy-to-install panel is manufactured from 30-gauge steel. Corrugated ribs give this metal roofing panel strength and structural integrity.

- Made from 30-gauge steel
- Plain galvanized
- Corrugated ribs for strength
- Easy to install
- Covers approximately 16 sq. ft.
- Note: Product may vary by store.
- MFG Brand Name : Fabral
- MFG Model # : 4736006000
- MFG Part # : 4736006000

[Return To Top](#)

SPECIFICATIONS

Assembled Depth (in.)	26.0 in	Assembled Height (in.)	96.0 in
Assembled Width (in.)	.50 in	Color Family	Grays
Commercial / Residential	Residential	Coverage Area (sq. ft.)	16 ft ²
Item Package Type	No Package	Manufacturer Warranty	None
Material	Steel	Product Length (in.)	96 in
Product Weight (lb.)	6.8	Product Width (in.)	26
Profile	F4 1/2 Metal	Roofing Product Type	Metal Roofing

[Return To Top](#)

CUSTOMER REVIEWS



SETBACK AND YARD REQUIREMENTS FOR ONE AND TWO FAMILY DWELLINGS & ACCESSORY STRUCTURES
SECTION 32, SUBSECTIONS, D-1c, D-2b, D-2e, & D-21

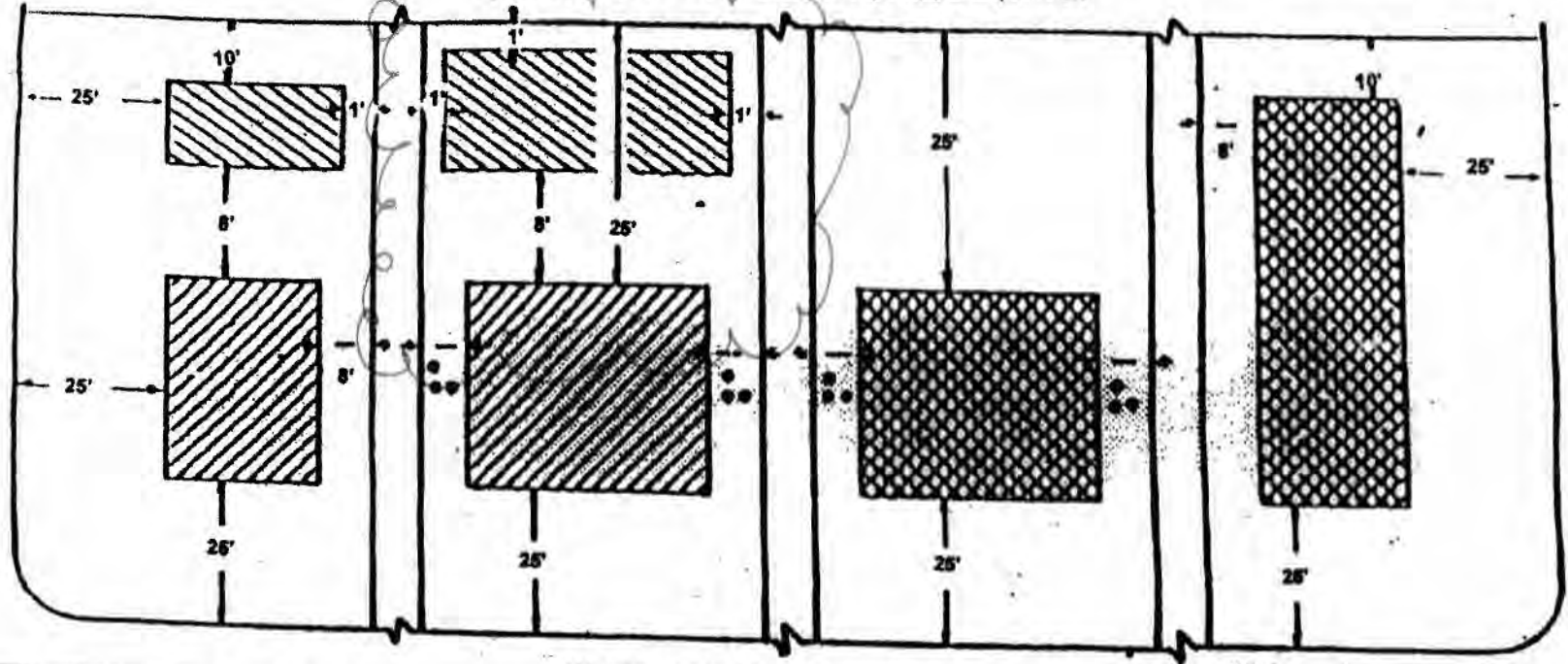

ALL DIMENSIONS ARE MINIMUM DIMENSION

SINGLE FAMILY DWELLING ONLY				TWO FAMILY DWELLING ONLY		
ZONE	TOTAL SIDE YARD	MINIMUM ON EITHER SIDE	DIFFERENCE ON OPPOSITE SIDE	ZONE	HEIGHT OF BUILDING	MINIMUM SIDE YARD ON EACH SIDE
R-20	30'	8'	22'	R-5 OR R2-7	25'	10'
R-10	24'	8'	16'		27.5'	11'
R-8	21'	8'	13'		30.0'	12'
R-6	18'	8'	10'		32.5'	13'
R-5	18'	8'	10'		35.0'	14'
R2-7	18'	8'	10'			

CORNER LOT FRONT THE SIDE HAVING THE SHORTEST DIMENSION ON A STREET REGARDLESS OF THE ARCHITECTURAL DESIGN OF THE HOUSE

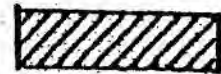

DWELLING



ONE STORY
ACCESSORY
BUILDINGS



DWELLING
ACCESSORY
BUILDINGS

Required setback - 1' from property line
 - 8' from existing structure

Required height - 25' (1.5 stories) or less