

Revised fence design for Fort Ethan Allen

July 30, 2013

The stainless steel “banker’s wire” fence system which we had originally included in the design was not even close to affordable for the project. We also had concerns about the brightness and appropriateness of the material.

To meet the budget and our aesthetic goals, we have designed a simple galvanized steel framework which will be powder coated for durability. The color will closely match the powder coated supports of the interpretive panels, and will blend in well with the surroundings.

We have selected a hand woven stainless steel mesh to be attached to the steel framework. The mesh is visually quiet and very beautiful, and offers a little “give” should a soccer player run into it.



Hand woven stainless steel mesh installed at the National Zoo

The same 2" mesh that we have specified for Fort Ethan Allen is shown, with the same black oxide finish. This installation uses steel cable rather than steel rod to support the mesh. The installation at Fort Ethan Alen will use 1/2" steel rod, which will maintain the geometry of the grid and alleviate the "sag." The mesh itself visually disappears, leaving the clean railing system visible. Steel components will be powder coated to match the interpretive panel frames.

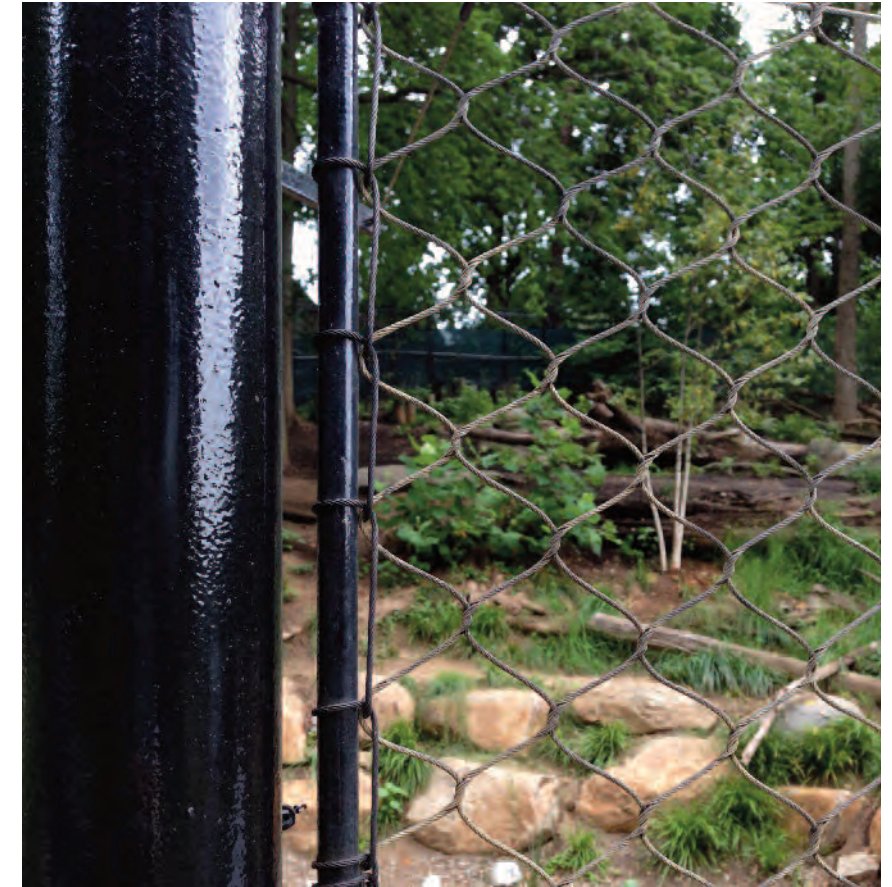

Hand laced attachment of steel mesh

The mesh is hand laced to the perimeter 1/2" steel rods using half and full hitches. All lacing wire rope will be fed into zinc plated copper swage sleeves and crimped to seal.

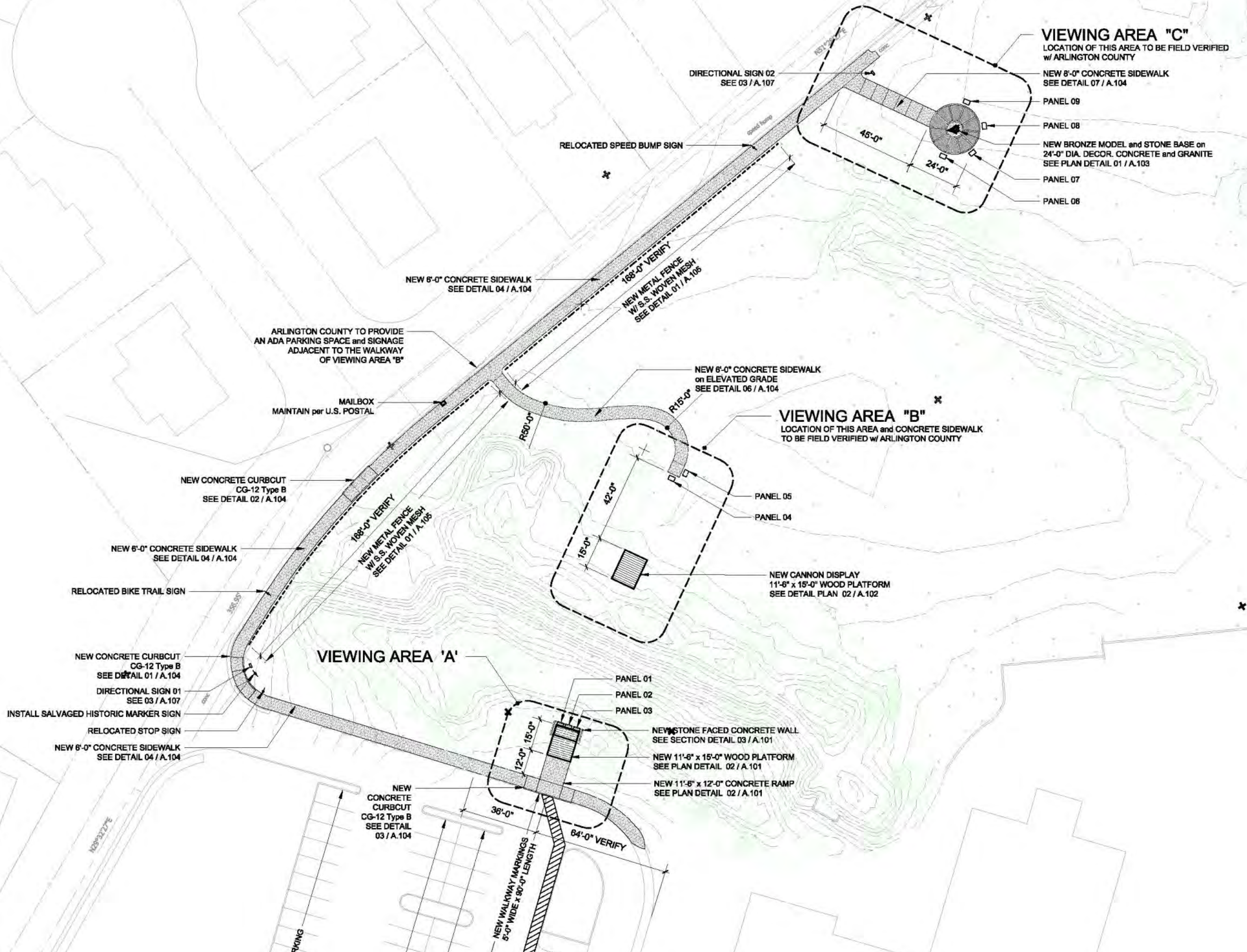

**Interpretive Design
for
Fort Ethan Allen Park**

Arlington County, Virginia
Department of
Community Planning,
Housing and Development

Neighborhood Services Division

2100 Clarendon Boulevard
Suite 700
Arlington, Virginia 22201

FasterKitty LLC
 Katherine Lenard
 3230 19th Street NW
 Washington DC 20010
 202-462-2386

MICHAEL J. WALKLEY, P.A.
 Consulting Engineers
 1700 Union Avenue
 Baltimore Maryland 21211
 410-889-7700
 410-889-7756

MANIFOLDdesign
 KAREN LEMMERT, Architect
 DAVID NAILL, Architect
 735 North Eutaw Street
 Baltimore MD 21201
 410-225-0037 KL
 410-225-0038 DN
 www.manifolddesign.com
 info@manifolddesign.com

MANIFOLD Design © 2013 All rights reserved.
 This document, including the design concept, is the property of
 MANIFOLD Design. Nothing contained herein may be used,
 reproduced, or distributed in any way or by any means without
 the express written permission of MANIFOLD Design.

100% Construction Documents
 August 6 2013

PROJECT Agreement #683-12

SITE PLAN

A.100

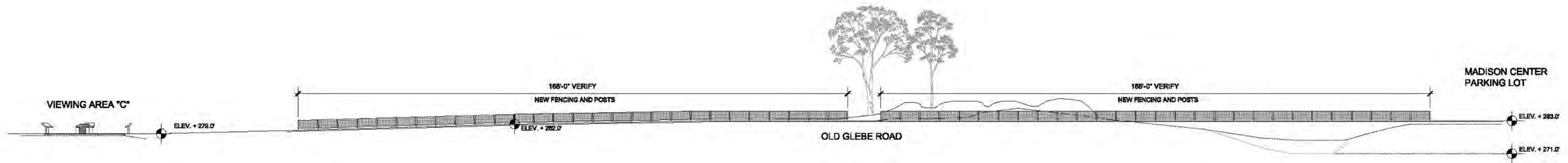

3 FENCE ELEVATION
1/16" = 1'-0"

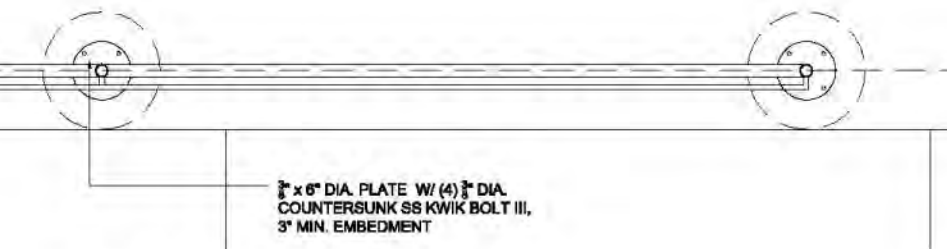
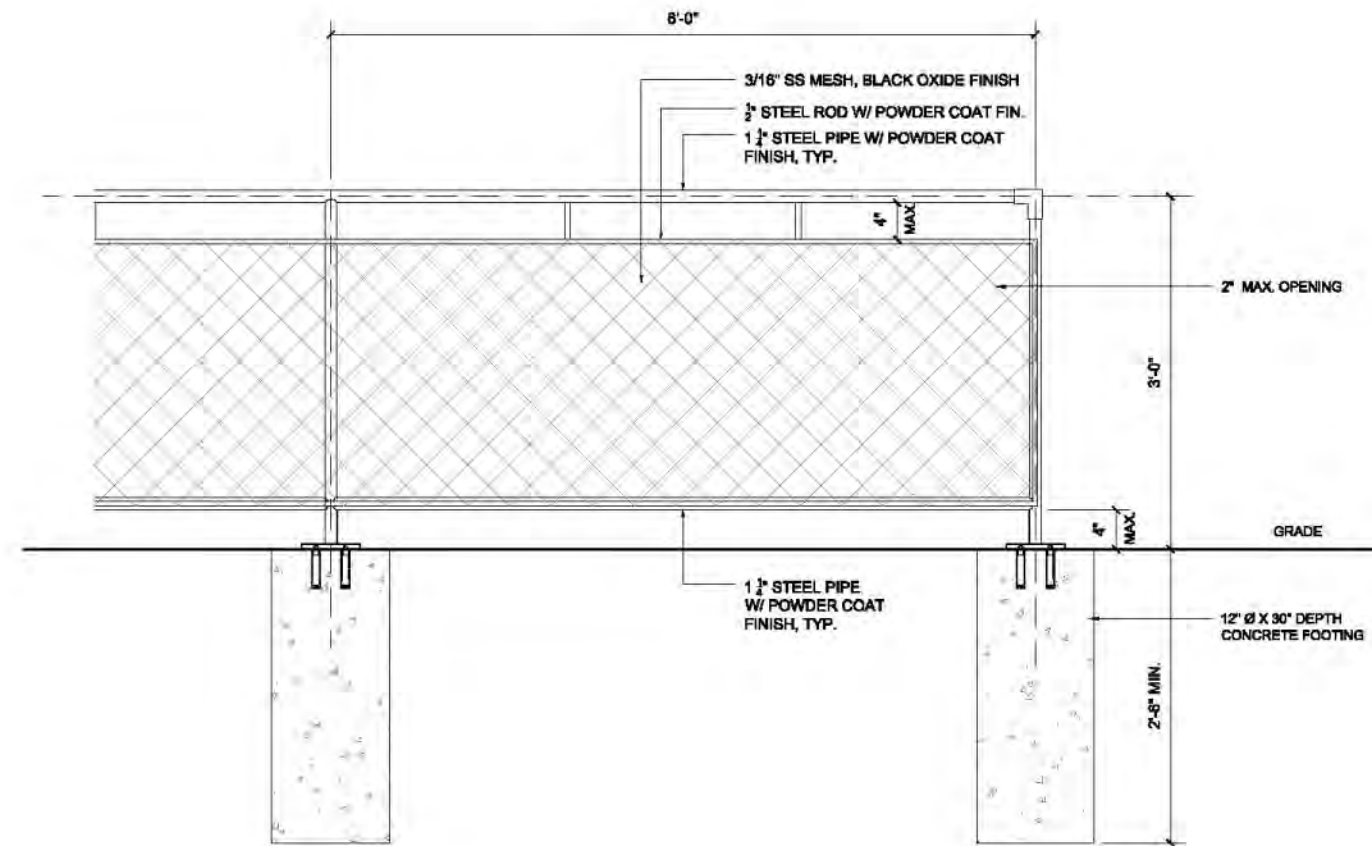

1 FENCING PLAN & ELEVATION
1" = 1'-0"

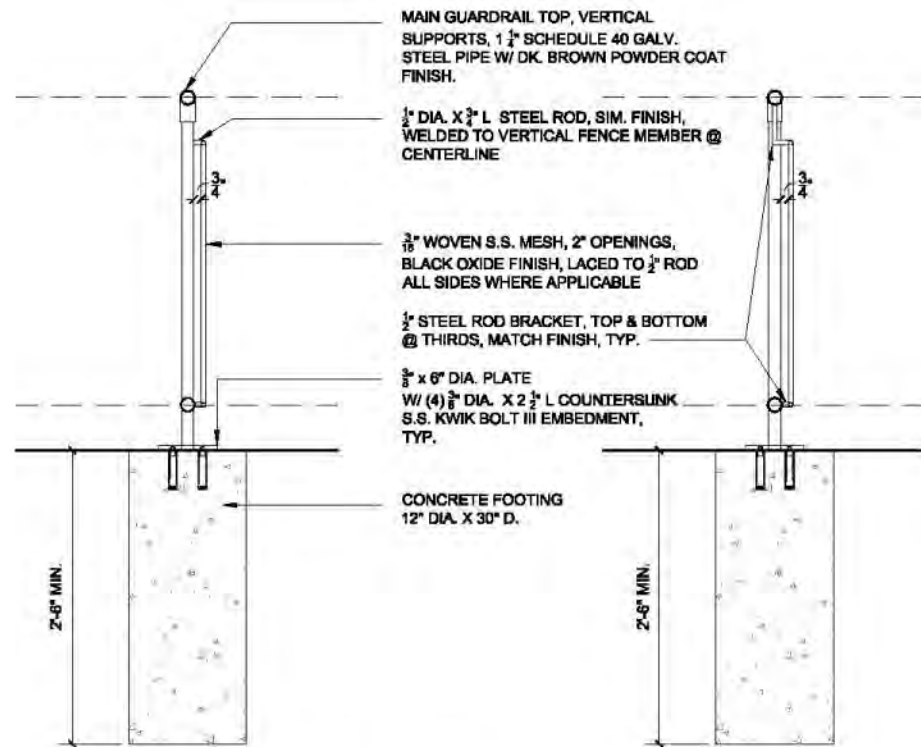

- NOTE:**
1. ALL MATERIAL FOR FENCE, EXCEPT MESH, TO BE GALV. STEEL W/ DK. BROWN POWDER COAT FINISH. ALL FINISH TO BE DONE PER ASTM D6386 STANDARDS.
 2. ALL WELDS TO BE GROUND SMOOTH
 3. ALL JOINTS B/W PIPE RUNS AND CONNECTIONS TO BE FLUSH, NOT OVERLAPPING.
 4. FABRICATOR TO PROVIDE DETAILED SHOP DRAWINGS FOR APPROVAL

B SECTION @ posts

A SECTION b/w posts

2 FENCING SECTION
1" = 1'-0"

NOTE:

ALL FENCING MATERIAL SHALL BE PROVIDED AND INSTALLED BY ARLINGTON COUNTY UNDER SEPARATE CONTRACT. D & F CONSTRUCTION TO PROVIDE FOOTINGS AS SHOWN.

Interpretive Design for Fort Ethan Allen Park

Arlington County, Virginia
Department of
Community Planning,
Housing and Development
Neighborhood Services Division
2100 Clarendon Boulevard
Suite 700
Arlington, Virginia 22201

FasterKitty LLC
Katherine Lenard
3230 19th Street NW
Washington DC 20010
202-462-2386

MICHAEL J. WALKLEY, P.A.
Consulting Engineers
1700 Union Avenue
Baltimore Maryland 21211
410-889-7700
410-889-7756

MANIFOLDdesign
KAREN LEMMERT, Architect
DAVID NAILL, Architect
735 North Eutaw Street
Baltimore MD 21201
410-225-0037 KL
410-225-0038 DN
www.manifolddesign.com
info@manifolddesign.com

MANIFOLD Design © 2013 All rights reserved. This document, including the design concept, is the property of MANIFOLD Design. Nothing contained herein may be used, reproduced, or distributed in any way or by any means without the express written permission of MANIFOLD Design.

100% Construction Documents
August 6 2013

PROJECT Agreement #683-12

FENCE DETAILS

A.105