

ARLINGTON COUNTY, VIRGINIA  
HISTORICAL AFFAIRS AND LANDMARK REVIEW BOARD  
APPLICATION FOR CERTIFICATE OF APPROPRIATENESS

DATE 7-5-2015 Z- \_\_\_\_\_ - \_\_\_\_\_ -HD \_\_\_\_\_ RPC# \_\_\_\_\_  
(TO BE COMPLETED BY STAFF)

DESIGNATED PROPERTY:

Name of Historic District Colonial Village III  
Address of Building SEE BELOW

OWNER:

Name Colonial Village III Condominium  
Address (if different) 1903 Key Blvd  
Phone (Home) \_\_\_\_\_ (Work) 703-525-5551  
EMAIL: CVAUGHAN@LEGUMNORMAN.COM

PERSON FILING APPLICATION, IF OTHER THAN OWNER:

Name Chuck VAUGHAN CVAUGHAN@LEGUMNORMAN.COM  
Address 1903 Key Blvd  
Phone (Home) \_\_\_\_\_ (Work) 703 525-5551  
Relationship to Applicant PROPERTY MANAGER

PROJECT ARCHITECT/ENGINEERS/CONTRACTORS:

PURPOSE OF APPLICATION:

Repair (change of materials)       Alteration       Addition       Fence  
 Demolition       New construction       Relocation       Outbuildings  
 Tree Removal       Grading       Sign       Other

Will an application related to this property go before any of the following?  Board of Zoning Appeals  
 Planning Commission  County Board  Other (please specify) \_\_\_\_\_

Does the proposed work require a building permit?  YES  NO  
Is any demolition anticipated?  YES  NO If yes, please describe \_\_\_\_\_

OVERVIEW OF PROPOSED WORK (ATTACH ADDITIONAL SHEETS IF NECESSARY):

Description:

Removal and replacement of the following trees: a maple tree adjacent to 1831 Wilson Blvd.; an oak tree on the west side of 1736 Queens Ln.; eight pear trees in front 1737 Queens Ln.; an elm tree in front of 1801 Queens Ln.; and a cherry tree in front of 1804 Queens Ln. (See attachments.)

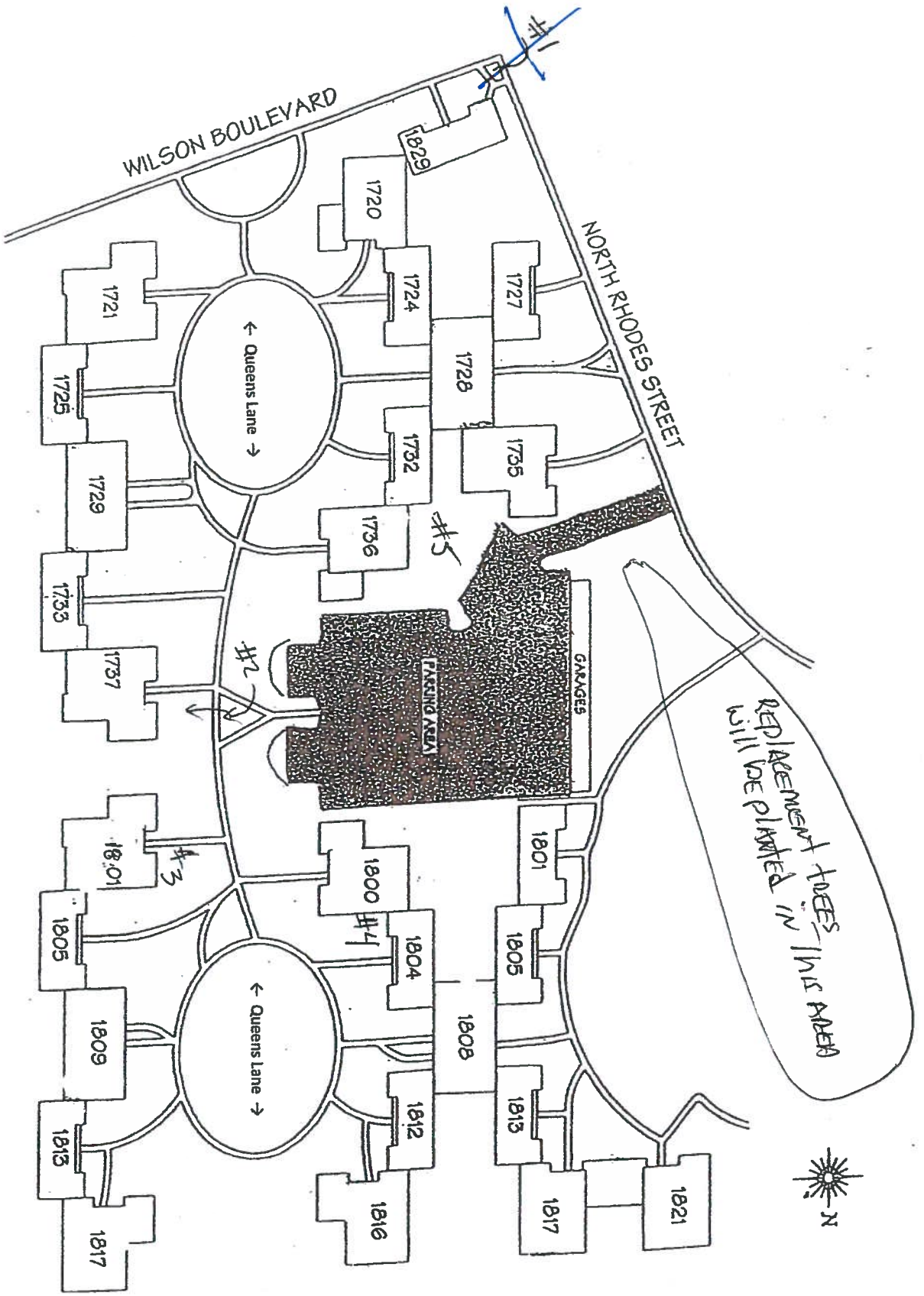

**SITE PLAN**  
NOT TO SCALE

**#1 Maple 1831 Wilson Blvd.**

This tree's crown has become lopsided because from being repeatedly pruned away from utility lines under which it is located. The west side of the tree is dying. We want to replace it with two trees: a hot pink crape myrtle in the removal location and a 4" caliper American Beech to be planted close to the streambed of Colonial Village Run





## #2 Eight Washington Pear Trees in front of 1737 Queens Ln.

The crowns of these trees are beginning to thin out. We would like to replace them in order to improve CVIII's landscaping. Their replacements will be an arrangement of medium height crape myrtles at the removal site and 8 American Hornbeams to be planted the stream bed of Colonial Village Run.



### #3 Siberian Elm at 1801 Queens Lane

This tree has suffered so much storm damage that most of its lateral branches look like stumps. We would like to replace it with two trees: a deciduous magnolia in the same location as the removal and a 4" caliper American Beech close the stream bed of Colonial Village Run.





#### #4 Kwanzan Cherry 1804 Queens Lane

This tree died over the winter. There wasn't single leaf on it this spring. Miscommunication with our tree service led to it being cut down at the same time that the Yellow Poplar that fell on 1801 Rhodes was removed. We would like to replace it with a 4" caliper American Red Bud to be planted in the same location as the removal.



**#5 Pin Oak behind 1736 Queen Lane**

This tree appears to be dying. It is losing more and more of its foliage every year. We would like to replace it with a 4" caliper American Beech close the stream bed of Colonial Village Run.

